

## ⚠ WARNING

---

- Read these instructions carefully before use the product and keep the manual for future reference. Your child's safety may be affected if you do not follow these instructions.
- Never leave the child unattended.
- Do not use this product once your child can sit up unaided or weight more than 9KG.
- This reclined cradle is not intended for prolonged period of sleeping.
- Never use the product on an elevated surface (e.g. a table).
- Always use the restraint system.
- Ensure that your child is kept away by folding and unfolding this product to avoid injury.
- Do not move or lift this product with the baby inside.
- This product does not replace a cot or a bed. Should your child need to sleep, then it should be placed in a suitable cot or bed.
- Only replacement parts supplied or recommended by the manufacturer / distributor can be used.
- This product is not a toy, do not let children play with it.
- Regularly examine the cord, plug, and the related other parts, in case of any damages, they must not be used.
- The infant swing must only be used with the recommended power adaptor.
- Never use the toy bar to carry the reclined cradle.

## ⚠ BATTERY CAUTION

---

- Non-rechargeable batteries are not to be recharged.
- Rechargeable batteries should only be charged under adult supervision.
- Rechargeable batteries are to be removed from the product before charged.
- Different types of batteries, or new and used batteries are not to be mixed.
- Take care to fit the batteries correctly observing the “+” and “-” sign marks on the battery and appliance.
- Exhausted batteries are to be removed from the product.
- The power supply terminals are not to be short-circuited.
- Assembled by adult is required.
- Removed batteries should be stored away from children.

◦

◦

# Parts List

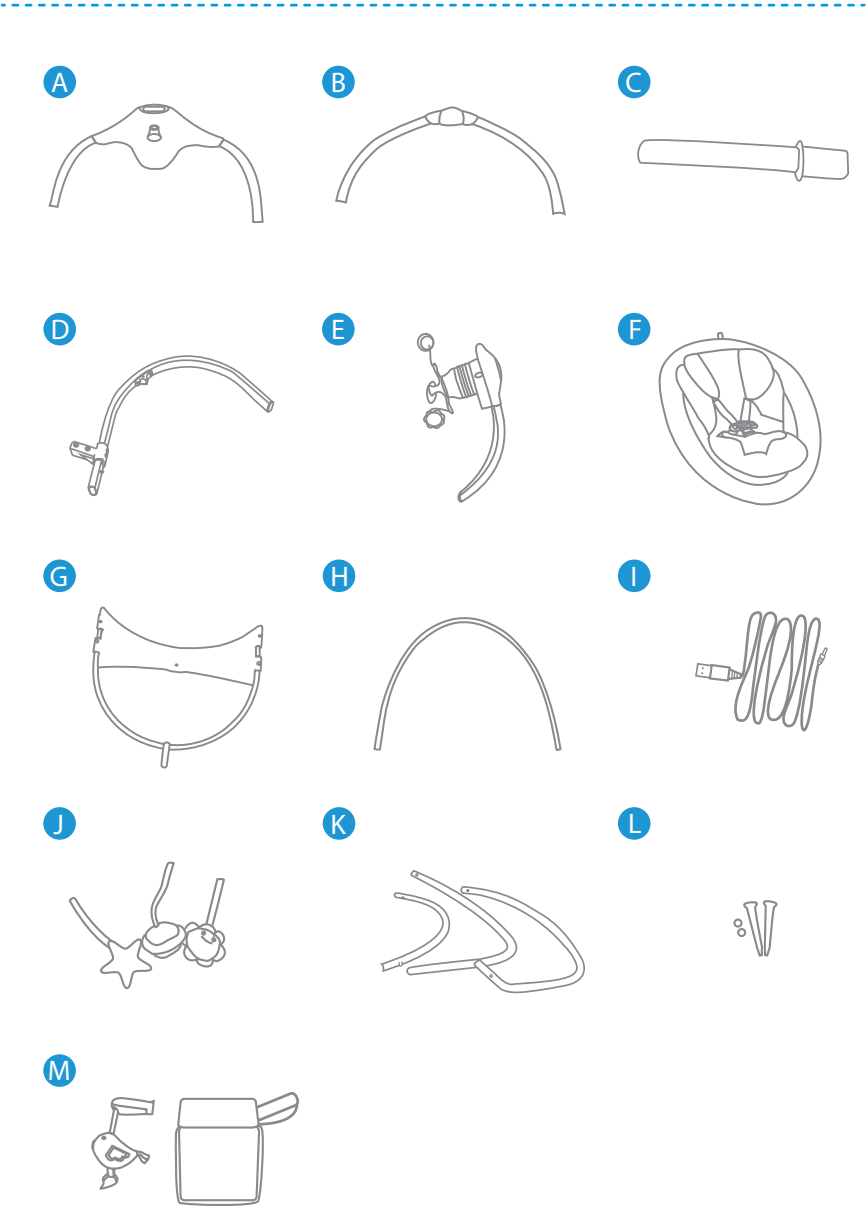

Unpack the carton,check all parts have been supplied.

- A. Base A \*1
- B. Base B \*1
- C. Joint tube \*1
- D. Swing arm \*1
- E. Main joint \*1
- F. Seat fabric \*1
- G. Upper seat support \*1
- H. Lower seat support \*1
- I. USB line \*1
- J. Swing Toy \*3
- K. Tubes of rocker (front, left ,right) \*1
- L. Nut/Screw \*2
- M. Rocker handle and storage bag \*1

# Swing Assembly

## 1 Install The Swing Frame

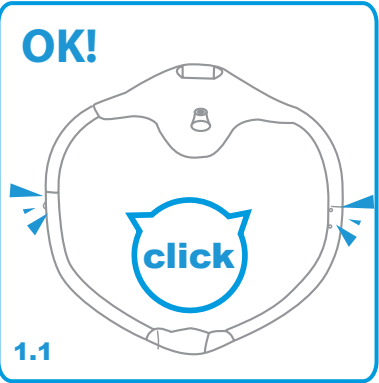

1.1 Press the button to connect tubes.

....

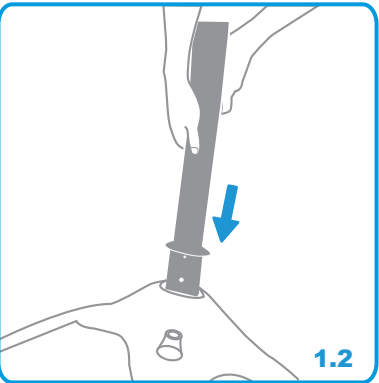
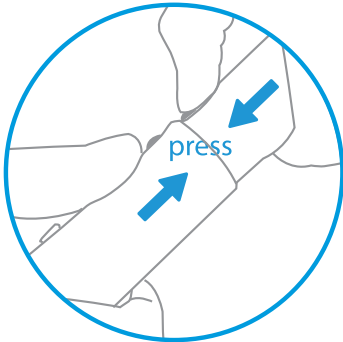

1.2 Connect the joint tube to the base.

....

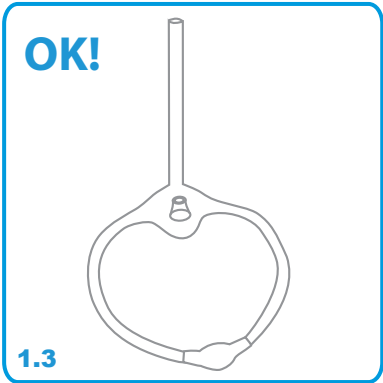
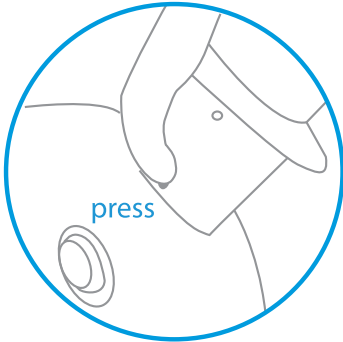

1.3 Installation is completed.

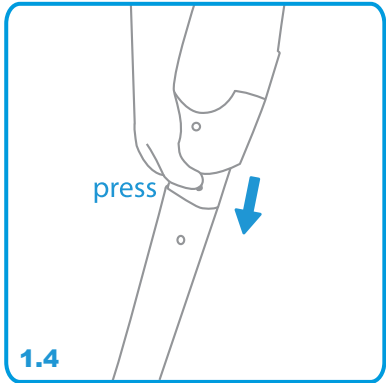

1.4 Press the button, connect the main joint to the joint tube.

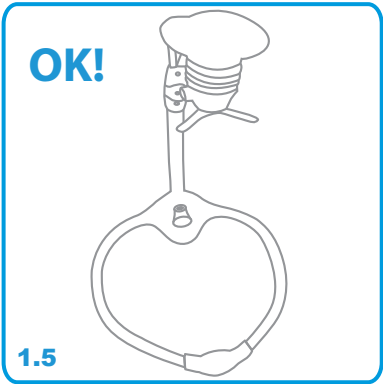

1.5 Swing frame installation is completed.

## 2 Install The Seat Fabric

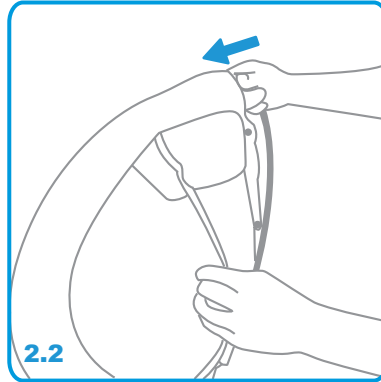
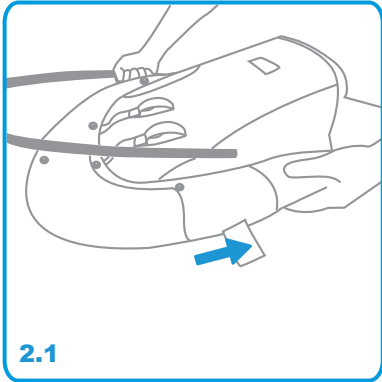

2.1+2.2 Insert the lower seat tube through the seat fabric.

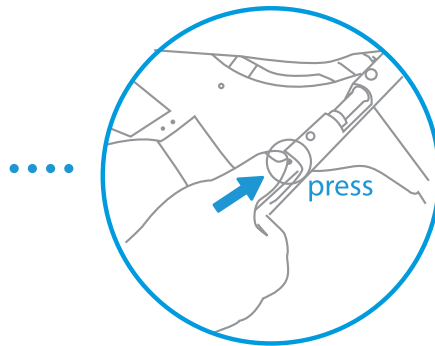
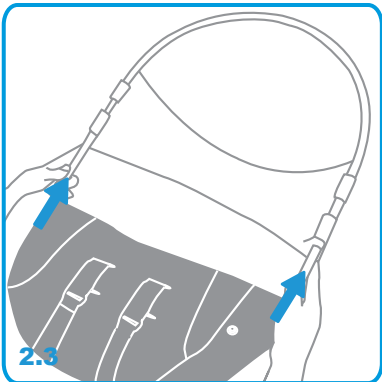

2.3 Press and hold the button, connect the upper and lower seat tubes.

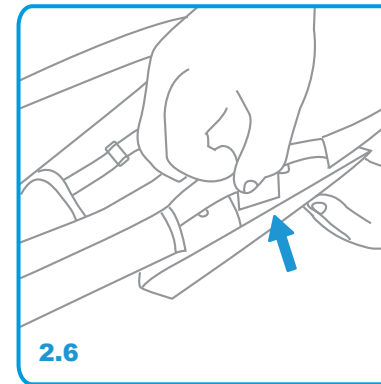
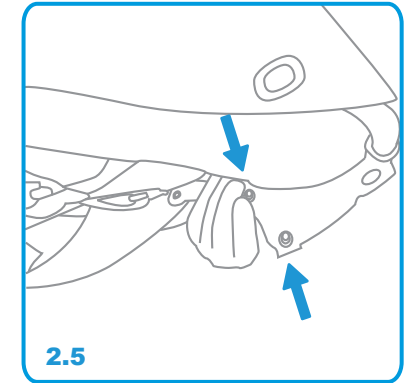
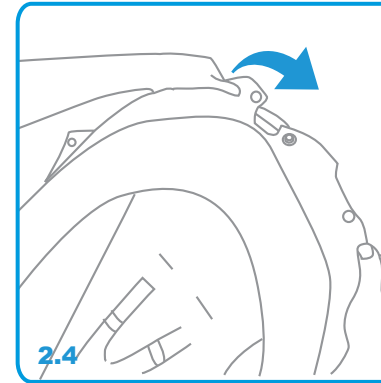

2.4-2.6 Fix the seat fabric around seat tube.



2.7 Seat fabric installation is completed.

## ③ 2 In 1 Swing Assembly

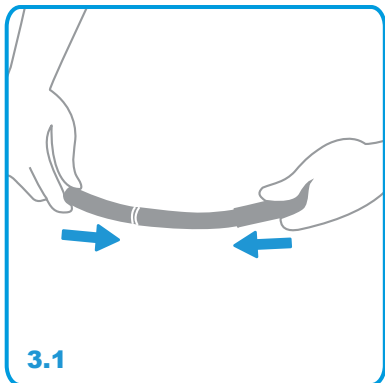

3.1 Connect the right rocker tube to the front rocker tube.

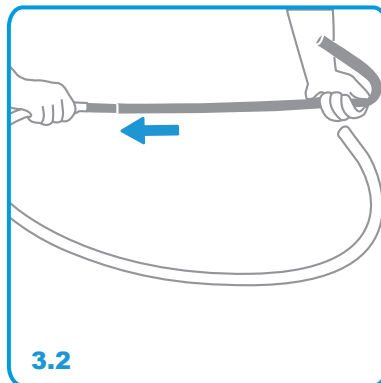

3.2 Connect the left rocker tube to the front rocker tube.

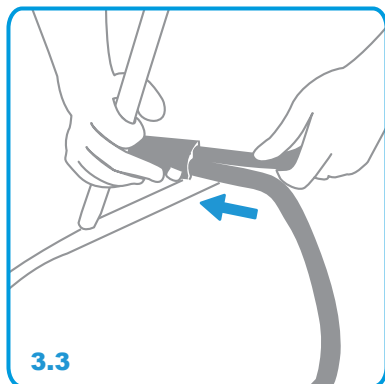

3.3 Connect the rocker tubes to the swing arm.

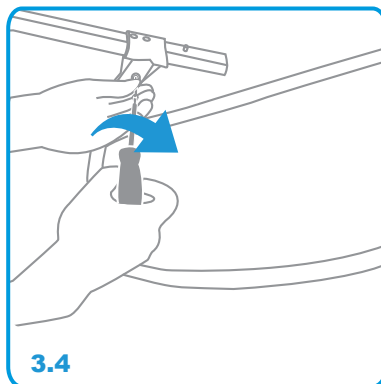

3.4 Tighten the screws and nuts.

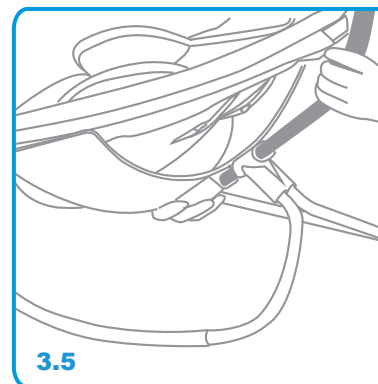

3.5 Connect the swing arm to the upper seat tube.



3.6 Rocker installation is completed.

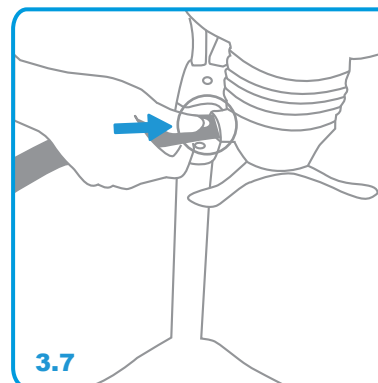

3.7 Press the button, connect the rocker to the swing frame.



3.8 2 in 1 swing installation is completed.

## 4 Toy Assembly 安裝玩具 安裝玩具

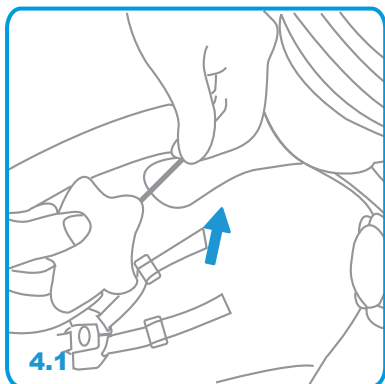

4.1 Install toys on swing.

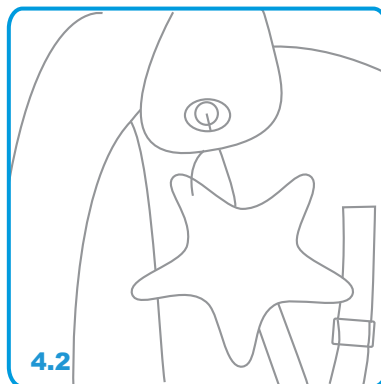

4.2 Installation is completed.

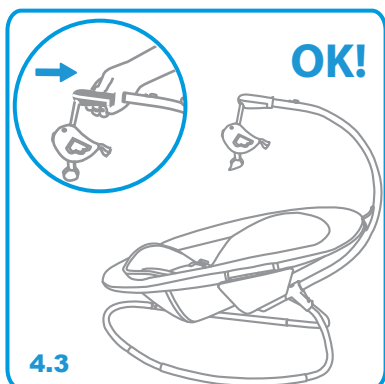

4.3 Install toy on rocker.

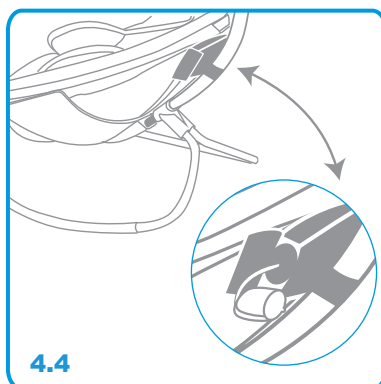

4.4 Fix the toy storage bag on the swing arm for toy storage.

## 5 Harness Operation 使用安全帶 使用安全帶

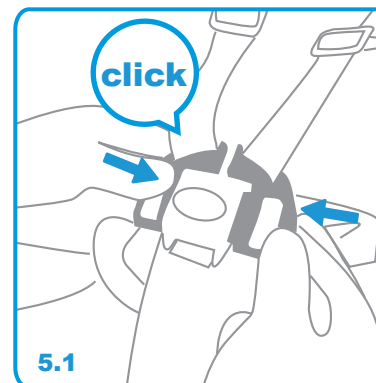

5.1 Buckle the latch waist belt at the same time.

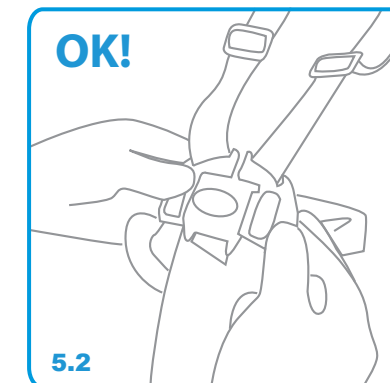

5.2 Complete buckle the latch waist belt.

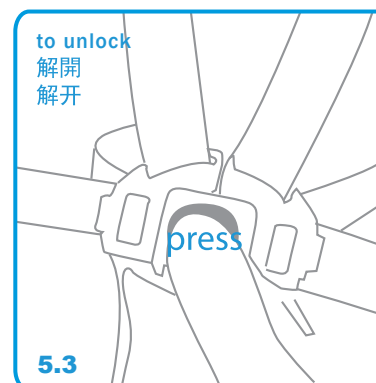

5.3 Press the middle button, both sides of the latch pop out, then the seat belt is unlocked.

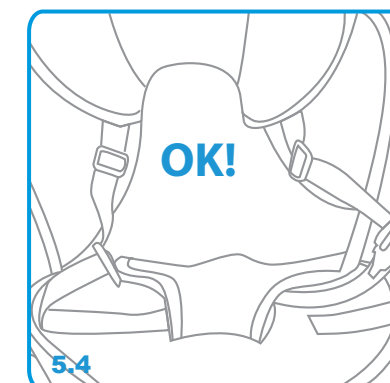

5.4 Unlock the seat belt.

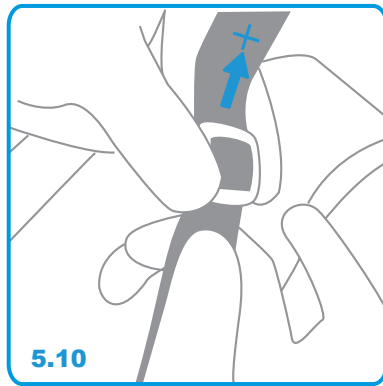
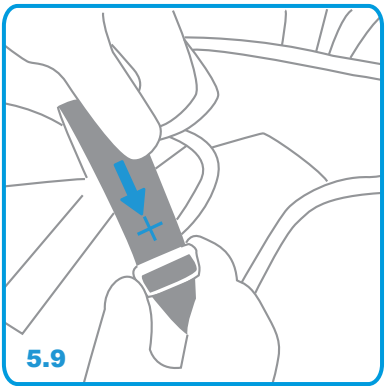
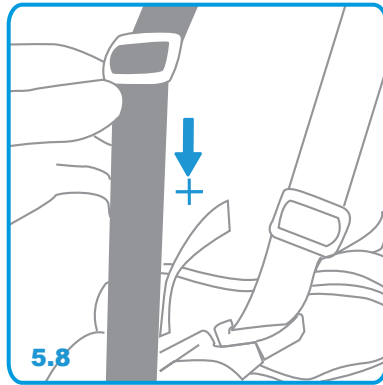
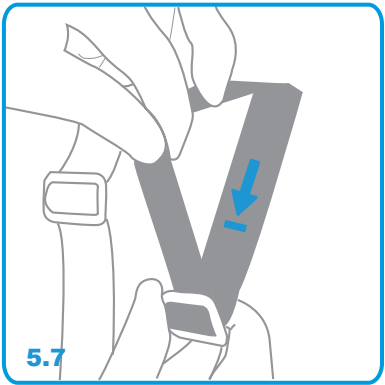
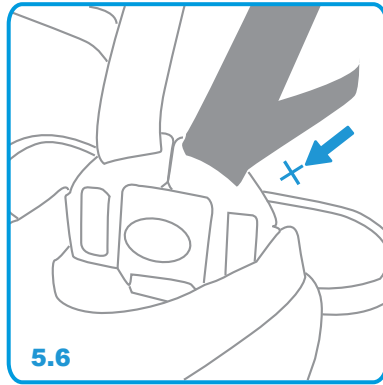
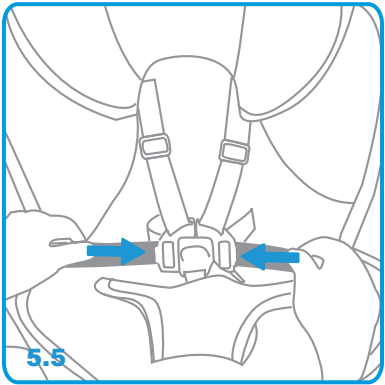

5.5-5.10 Adjust the shoulder straps.

## 6 The Controll Of Buttons 按鍵功能控制 按键功能控制

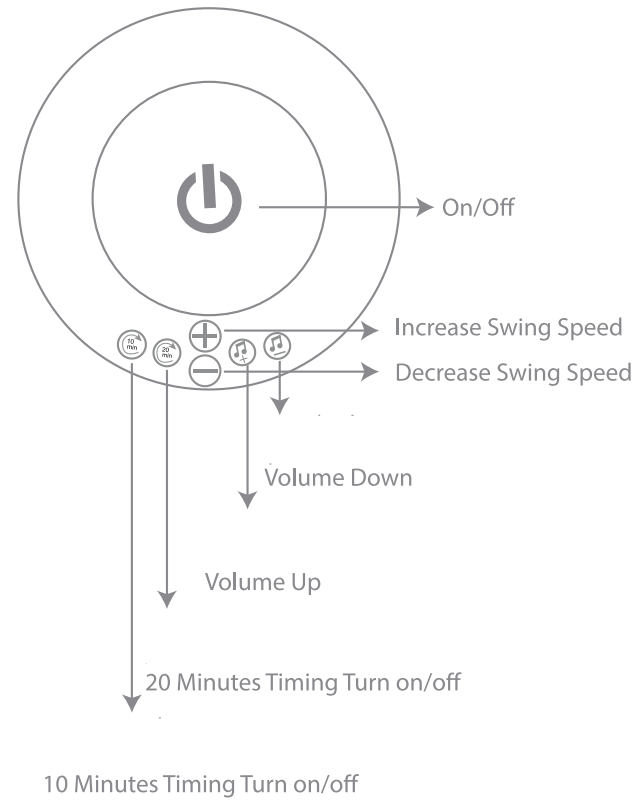



## SWAY

- There are three speeds for swaying.
- Press “+” button,press once is speed 1st; twice is speed 2nd,and thrice is speed 3rd.
- Press “-” button,when the swing is at speed 3rd,you need to press thrice to stop swaying.
- Press “-” button,speed 2,press twice; speed 1st,only press once.
- If the swing is not swaying and staying still,it will be no function when you press the “-” button.

## MUSIC VOLUME

- There are three levels of music volumes.
- Press “+” button,press once is volume 1st; twice is volume 2nd,and press thrice is volume 3rd.
- press “-” button,when the swing is at volume 3rd,you need to press thrice times to stop music.
- Press “-” button,volume 2rd,press twice; volume 1st,only press once.
- If the swing is not swaying and stay static,it will be no function when you press the “-” button.

## TIMING

- To set up timing function when sway or music is in operation.
- Press once is to start timing function,twice is for consequent operation.
- There are two timing functions,10 or 20 minutes.

## 7 Power Connection

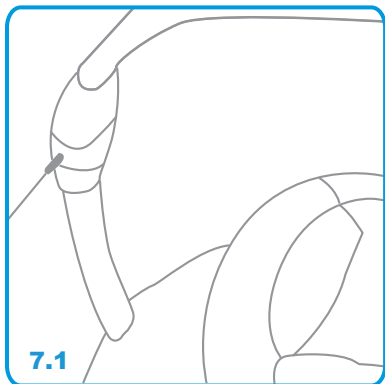

7.1 Use the regular cell phone charger, connect the USB line to the swing.

## ⚠ WARNING

ONLY USE THE RECOMMENDED POWER ADAPTOR  
(Output:DC 5V/6V Min.500mA, Eg: example phone chargers).

## 8 Seat Rotating

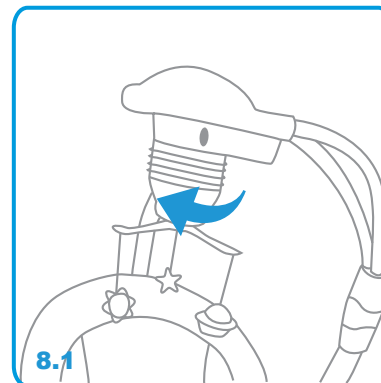

8.1 Press the button, to rotate to seat.

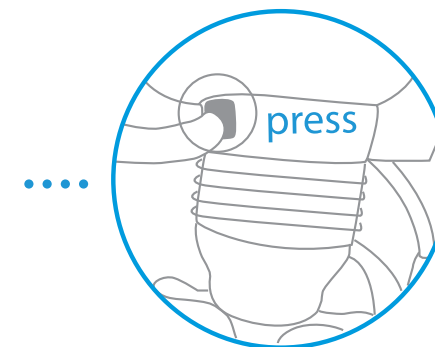

## 9 Battery Installation

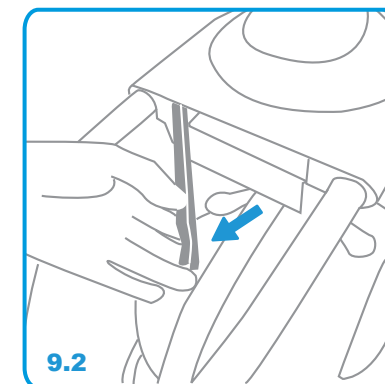
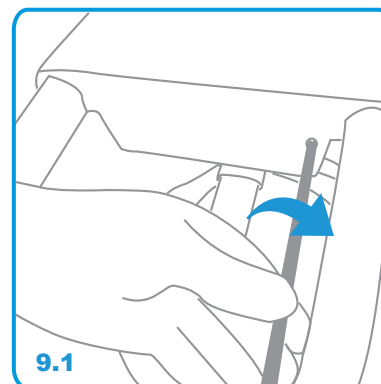

9.1+9.2 Loosen the screw on the battery cover with a screwdriver.

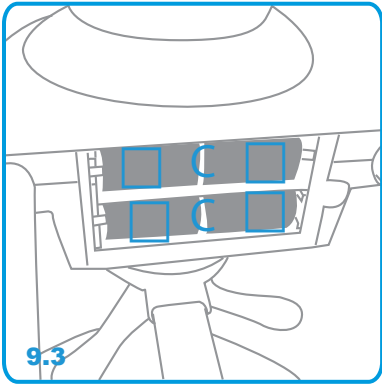

9.3 Put batteries in order.

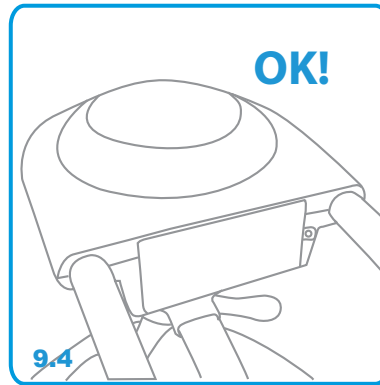

9.4 Close the battery box, battery installation is completed.

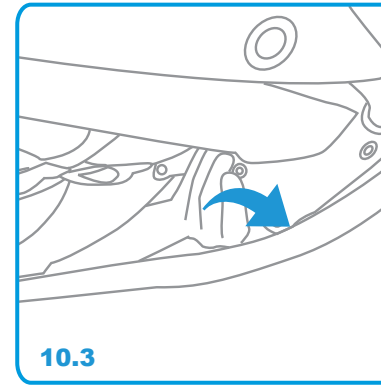

10.3 Unlock the buttons of the seat.

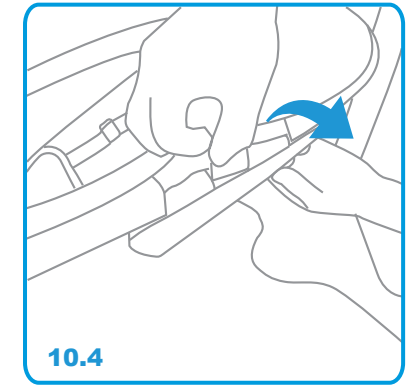

10.4 Unlock the buttons on both sides of the seat fabric.

10.4 解開座布兩邊固定扣。

10.4 解开座布两边固定扣。

## ⑩ Disassemble The Swing 收合鞦韆 收合秋千

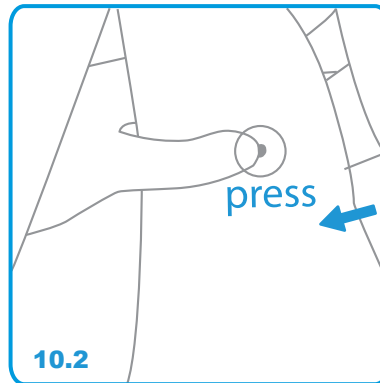
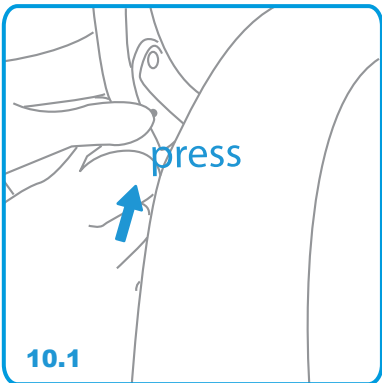

10.1+10.2 Press the buttons, remove the seat.

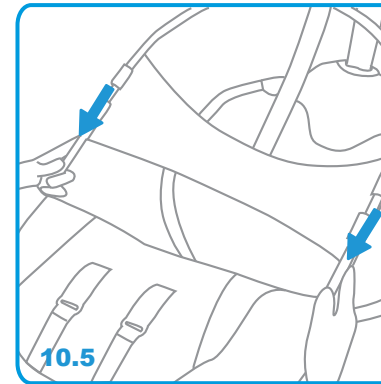

10.5 Press the buttons, remove the lower seat tube.

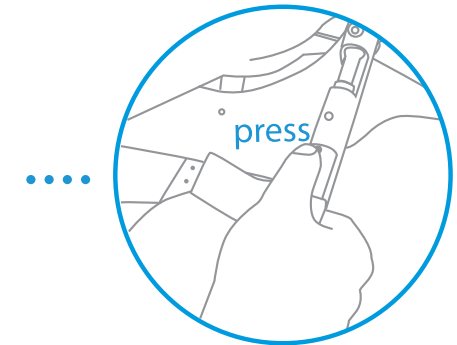

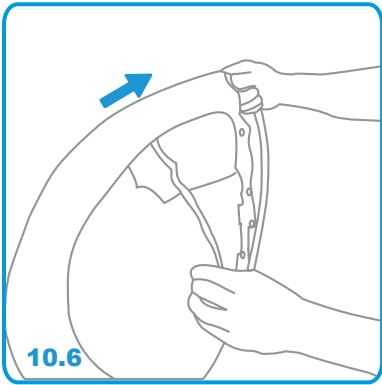

10.6 Remove the seat fabric from the lower tube.

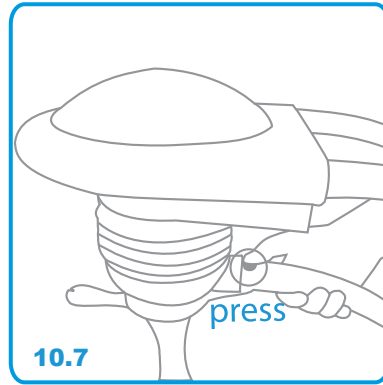

10.7 Press the button, remove the swing arm.

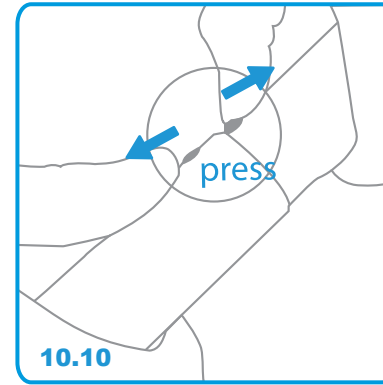

10.10 Press the button, remove the base tube.



10.11 Disassembly is completed.

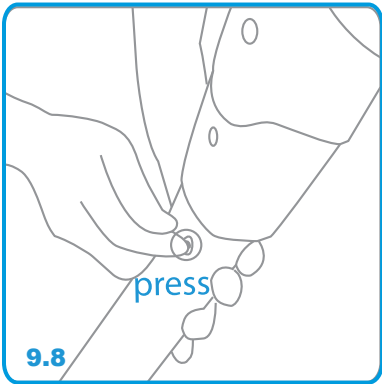

10.8 Press the button, remove the main joint.

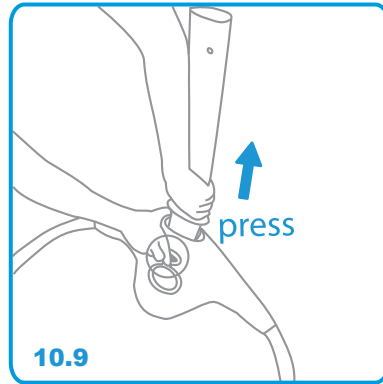

10.9 Press the button, remove the joint tube.

## Clean And Maintain

I

- This product is suitable for surface cleaning.
- To wash seat fabric with cold water and mild soap, and air dry.
- No bleach. Drip dry. Do not put in dryer. Do not iron or dry wet.
- Metal and plastic parts can be wiped clean with a soft cloth and dried with a soft cloth. Do not use abrasive cleaner or solvent.
- Keep product away from direct sunlight or high temperature while storage.
- Check the product for loosen screws, worn parts, torn material regularly and replace or repair parts immediately.